

TCB

FLIXTON ROAD

Existing cycle parking

24.4m

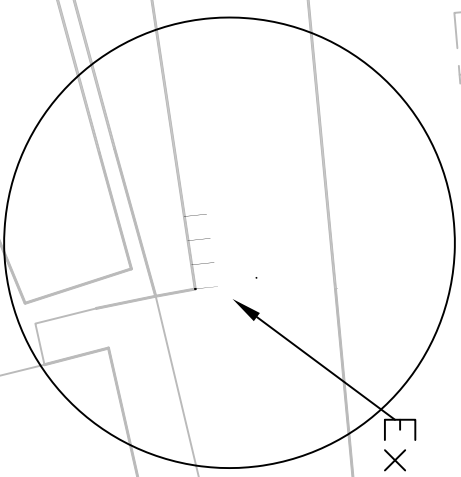

10 to 20

6 to 8

2

1

25.0m

Shelters

Urmston Station

Station Bridge

Reproduced from the Ordnance Survey mapping with the permission of the Controller of the Majesty's Stationery Office. Crown copyright. Unauthorised reproduction infringes Crown copyright and may lead to prosecution or civil proceedings. OS Licence No. 100023172 One Trafford Partnership 2018

Notes: No Dimensions to be scaled from this drawing. All Dimensions are to be checked on site.

REV.	DATE	REVISION DETAILS	DRAWN	CHECKED	APPROVED	DRAWN	CHECKED	APPROVED
			BV	CG	ST			

PROJECT & TITLE  
Flixton Road, Urmston  
Existing  
Location Plan



DRAWN	CHECKED	APPROVED	DRAWN	CHECKED	APPROVED
BV	CG	ST			
SCALE	DRAWING NO.				
NTS	C000201341-02A				
DATE					
Aug 20					
FILE PATH					
L:\00 Work Areas\Traffic & Transportation\08 MCF Bhs\Tranche 5 - Urmston\Launch\Park Road South					

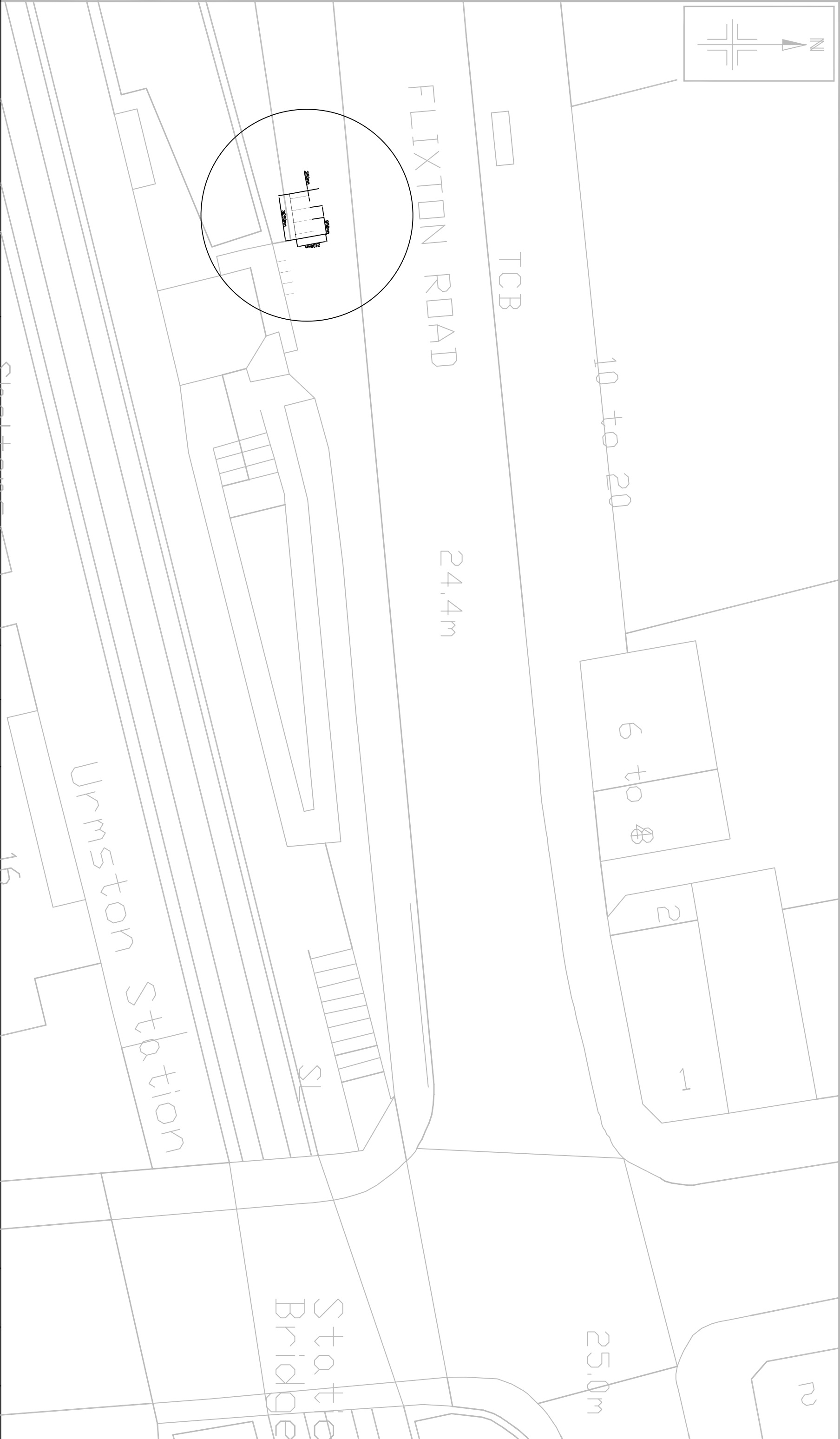
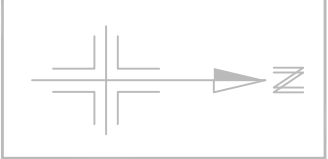

Reproduced from the Ordnance Survey mapping with the permission of the Controller of Her Majesty's Stationery Office © Crown copyright. Production of publication drawings Crown copyright and may lead to One Trafford Partnership OS Licence No. 100023172 2018

Notes: No Dimensions to be scaled from this drawing. All Dimensions are to be checked on site

REV.	DATE	REVISION DETAILS	DRAWN	CHECKED	APPROVED	DRAWN	CHECKED	APPROVED
			BV	CG	ST			

**PROJECT & TITLE**  
 Flixton Road, Urmston  
 Proposed Cycle Parking  
 Location Plan



SCALE	DRAWING NO.	REVISION
NTS	CO00201341-03A	-
DATE		
Aug 20		
FILE PATH		
L:\00 Work Areas\Traffic & Transportation\08 MCF Bids\Tranche 5 - Urmston\LaunchPark Road South		

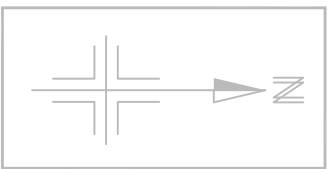

TOCB

F L I X T O N R O A D

Installation of new  
cycle Bike Port

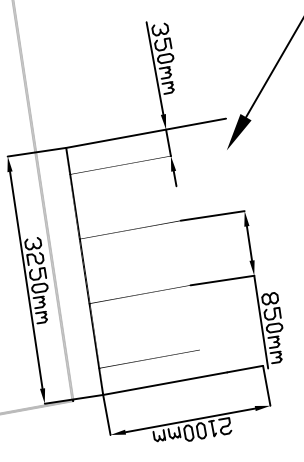

Proposed location of  
existing cycle parking

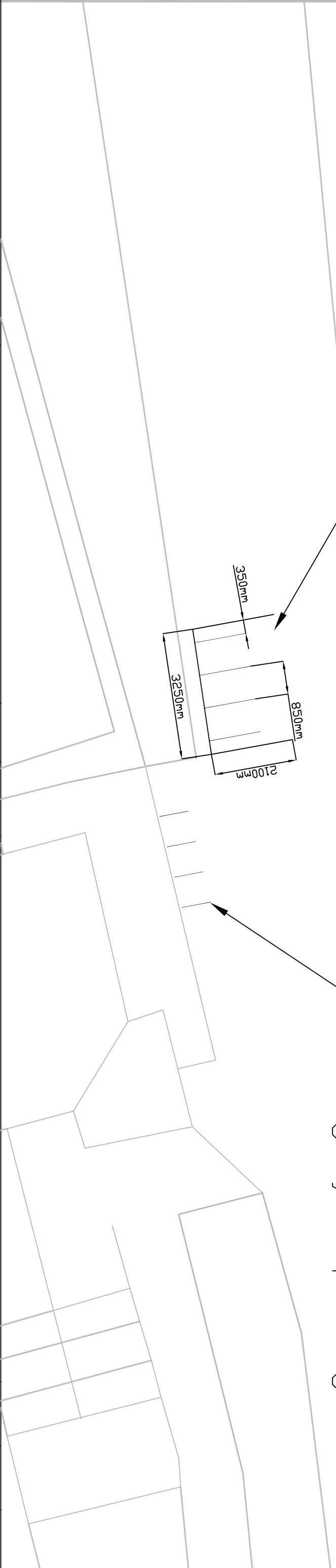

Reproduced from the Ordnance Survey mapping with the permission of the Controller of Her Majesty's Stationary Office © Crown copyright. Production of publication drawings Crown copyright and may lead to One Trafford Partnership OS Licence No. 100023172 2018

Notes: No Dimensions to be scaled from this drawing. All Dimensions are to be checked on site

REV.	DATE	REVISION DETAILS

DRAWN	CHECKED	APPROVED	DRAWN	CHECKED	APPROVED
BV	CG	ST			

PROJECT & TITLE  
Flixton Road, Urmston  
Proposed Cycle Parking  
Location Plan



DRAWN	CHECKED	APPROVED	DRAWN	CHECKED	APPROVED
BV	CG	ST			
SCALE	DRAWING NO.				
NTS	CO00201341-04A				
DATE					
Aug 20					
FILE PATH					
L:\00 Work Areas\Traffic & Transportation\08 MCF Bids\Tranche 5 - Urmston\LaunchPark Road South					

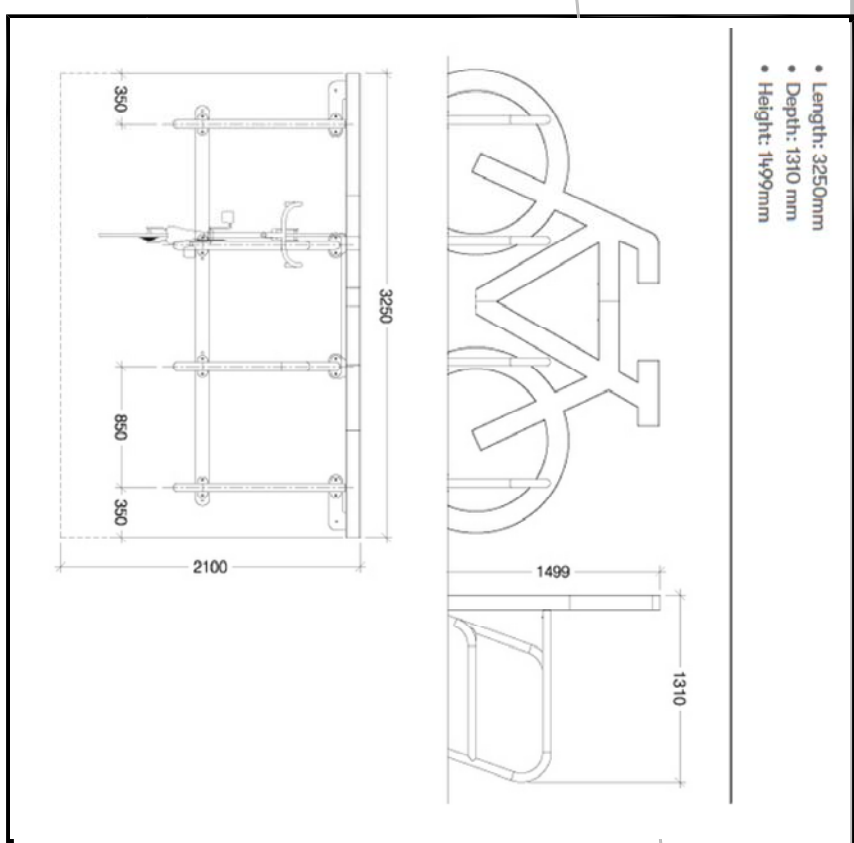

- Length: 3250mm
- Depth: 1310 mm
- Height: 1499mm

## PRODUCT BROCHURE

3250mm x 1310mm | Weight: 120kg



The Bike Port is an eye-catching cycle parking solution that provides space for 8 bicycles in a standard car parking bay. The bold outline of a car demonstrates the space efficiency of bikes. This product is easy to transport, assemble and install, making it a great solution for both temporary and permanent cycle parking.

### Features

- 8 spaces (4 racks per unit)
- Free-standing or bolted to the ground
- Signifies bicycle parking and is easily visible at a distance
- Flat pack design, easy to transport and set up
- Perfect for both events and permanent cycle parking



8 bikes in one parking space



Easy to assemble



Custom branding options

### Materials

- Racks: Mild steel, nylon powder coated
- Body: Aluminium, polyester powder coated

### Options

- Custom branding and colour options available

### Other Details

- Made in Britain
- Standard colour: Green (RAL 6018)



## Dimensions

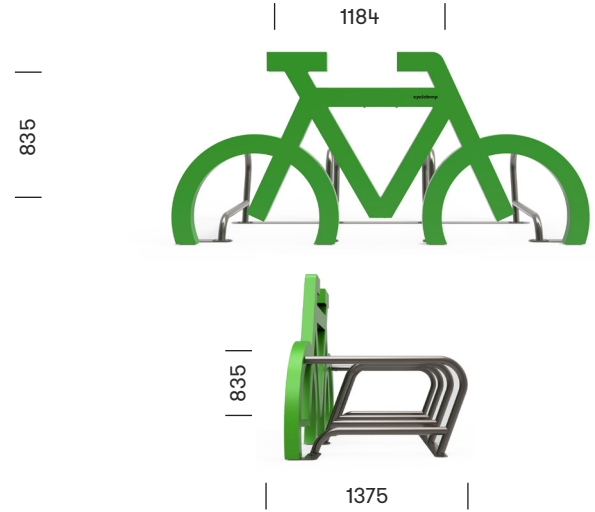
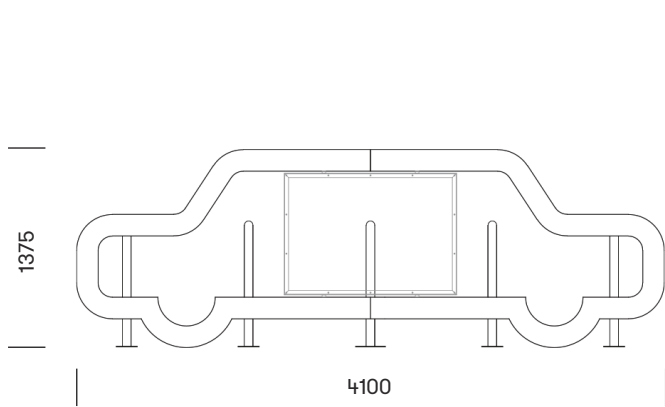

## Installation recommendations



## Warranty

Design: 1 year warranty

Cycle racks: 10 year guarantee

**For further information please contact Cyclehoop Ltd.**

Email: [info@cyclehoop.com](mailto:info@cyclehoop.com)

Phone number: +44 (0)20 8699 1338

Opening hours: Monday - Friday 9:00 - 18:00



Urmston

UAPPL

